

APPLICATIONS

Vandal Resistant, Security Lighting for Public Housing Developments, Schools, Mental Hospitals, Penal Institutions, Public Garages, Ramps, and areas subject to vandalism. Ideal for mirror and sink lighting in public washrooms, and waiting rooms. Design provides a "Super strength" wrap around polycarbonate diffuser, for medium duty service. Optional tamperproof screws are available.



SPECIFICATIONS

CONSTRUCTION: Die formed of 16 gauge prime cold rolled steel, rigidly fabricated to insure true and perfect alignment.

SHIELDING: One piece heavy gauge precision extruded of clear, light stabilized polycarbonate LEXAN®, with prismatic bottom and longitudinal side prisms directing side light upward, out of the glare zone. LEXAN® has extremely high impact strength and is almost impossible to break, removable for relamping by removal of the end caps.

MOUNTING: Surface mounted either horizontally or vertically on the wall, or surface mounted flush on the ceiling, singly or in continuous rows. For continuous row mounting, one set of end caps are eliminated and replaced with a joiner band to prevent light leakage between the two diffuser ends. Specify all continuous row lengths so that the proper accessories may be provided. End caps are used at the ends of rows and on individual units. Adequate knockouts and holes are provided for mounting and feeds.

ELECTRICAL: Thermally protected class "P" Energy Saving Instant Start HPF 270MA BIAx (Twin Tube), 265MA-T8 electronic ballasts standard for 118V 60 Hz operation. Other ballasts, voltages and frequencies available, consult factory. (See OPTIONS listing).

FINISH: All steel component parts are completely protected against rust and discoloration by an Anchored Process and coated with 365° sprayed baked white synthetic enamel for maximum durability, providing a high reflectance efficiency. Other finishes available, consult factory.

CERTIFICATION: The VANDALEX® is U.L. and C.U.L. listed and bears the label of the I.B.E.W./AFL-CIO, Local #3.

VANDALEX® and LEGION® are registered trademarks of LEGION LIGHTING CO., INC.
 LEXAN® is a trademark of General Electric.
 BIAx® is a trademark of G.E. Lighting.

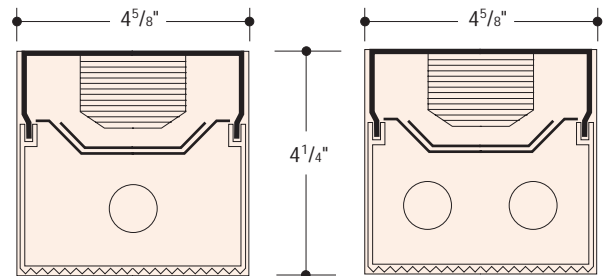

1 Lamp

2 Lamps

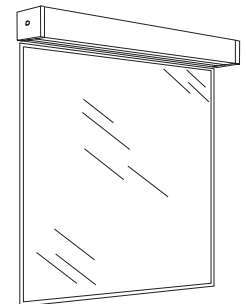
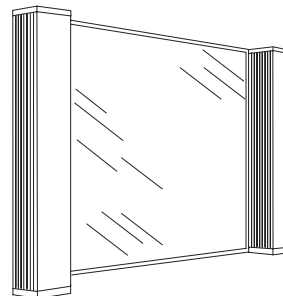

ORDERING DATA

| Cat. No. | No. and Type Lamps | Nominal Dimensions | Wt. |
|----------------|---------------------|---------------------------------------|-----|
| 19-117-UBP EBO | 1-FO17-OCT-T8 | 4 ⁵ / ₈ " x 24" | 8 |
| 19-1BX40-UBP | ▲ 1-F40TT/RS | | |
| 19-217-UBP EBO | 2-FO17-OCT-T8 | | |
| 19-125-UBP EBO | 1-FO25-OCT-T8 | 4 ⁵ / ₈ " x 36" | 11 |
| 19-225-UBP EBO | 2-FO25-OCT-T8 | | 12 |
| 19-132-UBP EBO | 1-FO32-OCT-T8 | 4 ⁵ / ₈ " x 48" | 16 |
| 19-232-UBP EBO | 2-FO32-OCT-T8 | | 17 |
| 19-2BX40-UBP | ▲ 2-F40TT/RS TANDEM | | |

▲ F40TT/RS is the ANSI designation of various lamp manufacturers, i.e. G.E. Lighting "BIAX", Philips "PL", Osram "Dulux L", Sylvania TWIN TUBE. For F50TT/RS lamp change catalog number. Example: 19-2BX50-UBP, and consult factory.

BIAX™ is a trademark of G.E. Lighting.
 LEXAN® is a trademark of General Electric.
 OCTRON™ is a registered trademark of SYLVANIA.

OPTIONS

Suffix "DIM" after catalog no. for dimming ballast.
 Suffix "LT" after catalog no. for cold weather ballast.
 Suffix "EM" after catalog no. for emergency battery pack, see price list for types.
 Suffix "DL" after catalog no. for damp location.
 Suffix "TP" after catalog no. for tamper proof spanner head screws, set of 6. Tamperproof screwdriver available.
 Change suffix "UBP" to "ACPDR" for 100% DR acrylic plastic.
 Consult factory for minimum quantity order.

ENERGY SAVING BALLASTS Where applicable (consult factory).
 Suffix "ESB" after catalog number, then / and one of the following:

ELECTRONIC

- "EBO"-Electronic T8 Octron Ballast
- "EBDO"-Electronic T8 Dimming Ballast
- "EBX"-Electronic (BIAX) Twin Tube Ballast
- "EBDX"-Electronic (BIAX) Twin Tube Dimming Ballast

BACK PLAN

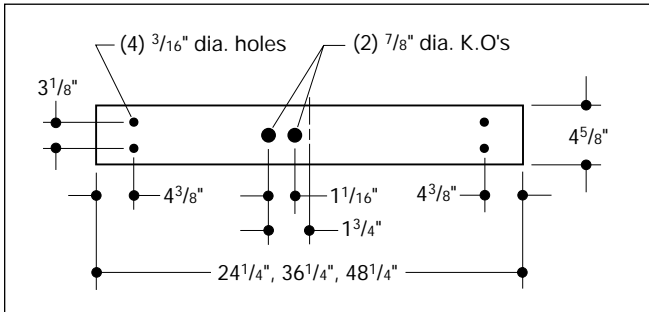

PHOTOMETRICS

ONE LAMP UNIT

| Floor | 20% | | | | | |
|---------|---------------------|-----|-----|-----|-----|-----|
| Ceiling | 80% | 70% | 50% | 50% | 30% | |
| Walls | 70% | 50% | 70% | 50% | 50% | 30% |
| RCR | ZONAL CAVITY METHOD | | | | | |
| 1 | .71 | .67 | .68 | .64 | .59 | .58 |
| 2 | .64 | .58 | .61 | .55 | .51 | .47 |
| 3 | .56 | .51 | .55 | .49 | .44 | .40 |
| 4 | .53 | .45 | .51 | .43 | .39 | .34 |
| 5 | .48 | .39 | .46 | .38 | .35 | .30 |
| 6 | .44 | .35 | .42 | .34 | .31 | .26 |
| 7 | .41 | .31 | .39 | .30 | .28 | .23 |
| 8 | .38 | .28 | .36 | .27 | .25 | .20 |
| 9 | .35 | .25 | .33 | .24 | .22 | .17 |
| 10 | .32 | .23 | .31 | .22 | .20 | .16 |

TWO LAMP UNIT

| Floor | 20% | | | | | |
|---------|---------------------|-----|-----|-----|-----|-----|
| Ceiling | 80% | 70% | 50% | 50% | 30% | |
| Walls | 70% | 50% | 70% | 50% | 50% | 30% |
| RCR | ZONAL CAVITY METHOD | | | | | |
| 1 | .64 | .60 | .61 | .58 | .53 | .51 |
| 2 | .58 | .52 | .55 | .50 | .46 | .42 |
| 3 | .53 | .46 | .50 | .44 | .40 | .36 |
| 4 | .48 | .40 | .45 | .39 | .35 | .31 |
| 5 | .44 | .35 | .41 | .34 | .31 | .27 |
| 6 | .40 | .32 | .38 | .30 | .28 | .23 |
| 7 | .37 | .28 | .35 | .27 | .25 | .21 |
| 8 | .34 | .25 | .32 | .24 | .22 | .18 |
| 9 | .31 | .23 | .30 | .22 | .20 | .16 |
| 10 | .29 | .21 | .28 | .20 | .18 | .14 |

Information supplied primarily for illustrative purposes, subject to change.
 Consult factory for verification and minimum quantity orders.

