

APPLICATIONS

The COMFORT-LUME® WW offers a new and attractive alternative to present-day conventional wall wash lighting systems. A recess direct/indirect downlight emitting glare free light with a soft and harmonious blend. Making the environment comfortable and appealing. Harshness is eliminated and no obtrusive dark protrusions below the ceiling line, leaving a clean uncluttered ceiling. The specifiers' choice with a new look, for use in Offices, Showrooms, Schools, Lobbies, Corridors, Libraries, Hospitals, and Conference Rooms.

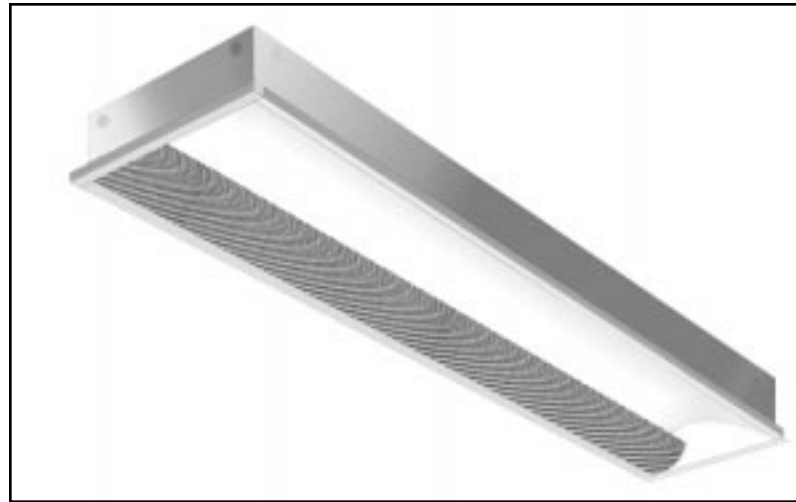

SPECIFICATIONS

HOUSING: Die formed of 20 gauge cold rolled prime steel, rigidly fabricated, and electrically welded to insure true and perfect alignment.

SOCKET PLATE: Die formed of code gauge cold rolled steel, securely mounted, socket accessible for maintenance.

REFLECTOR: CAD/CAM designed heavy gauge cold rolled steel formed to optically correct contour to provide precise light distribution with maximum efficiency, and effective glare control, removable to access wiring. XTALD-XTRALUME® energy efficient reflector available (see OPTIONS listing).

LAMP SHIELD: One piece heavy gauge perforated metal, precision formed and integrated with a white acrylic overlay and easily lowered for relamping without the use of tools.

ELECTRICAL: Thermally protected Class "P" Energy Saving Rapid/Instant Start HPF, 270MA-Biax (Twin Tube) electronic ballasts, or T5 HPF, 460MA Rapid Start Electronic ballasts for 118V 60 Hz operation standard. Other electronic ballasts, other voltages and frequencies available, consult factory. (See OPTIONS listing).

MOUNTING: Designed to integrate into most standard ceilings. LEVEL-JACKS are supplied on concealed mechanical FLUSH TRIM units only. For grid type ceilings, unit rests on the flanges of the exposed spline or tee. Fine Line Clips are supplied on units used in Fine Line type ceilings. See ceilings and specify type. Knockouts and wiring access plate are provided on back, with additional knockouts on ends for feed and thru-wiring.

FINISH: All steel component parts are completely protected against rust and discoloration after fabrication through an automated conveyORIZED multi-stage phosphate bonding process. Finished with an electrostatic baked matte white Tex-Tone™ polyester thermosetting powder coating. This electronic computer controlled integrated system assures consistent 88%+ reflectance efficiency and maximum durability.

CERTIFICATION: The COMFORT-LUME® WW Series 5812WW/5814WW is U.L. and C.U.L. listed and bears the label of the I.B.E.W./AFL-CIO, Local #3. Optionally U.L. and C.U.L. listed for Damp Location "DL".

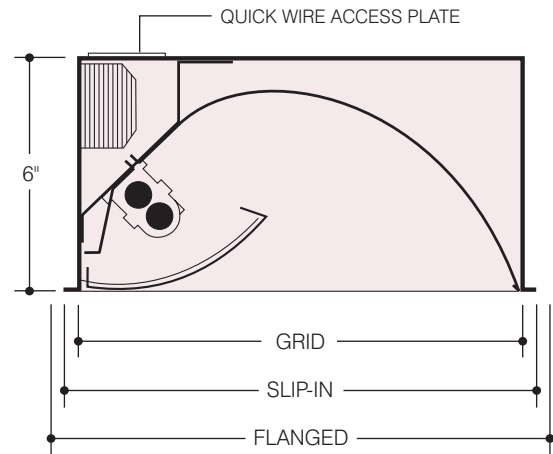

Nom. Size	GRID	SLIP-IN	FLANGED
1' x 2'	11 ³ / ₄ " x 23 ³ / ₄ "	11 ¹⁵ / ₁₆ " x 23 ¹⁵ / ₁₆ "	13" x 25"
1' x 4'	11 ³ / ₄ " x 47 ³ / ₄ "	11 ¹⁵ / ₁₆ " x 47 ¹⁵ / ₁₆ "	13" x 49"

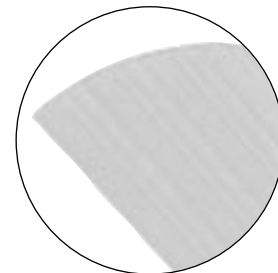

For a HI-TECH visual appearance, a lineal ribbed matte diffuse XTRALUME® reflector is optionally available in lieu of the standard white TEX-TONE™ reflector, add suffix "XTALD" to catalog number and consult factory.

COMFORT-LUME®, XTRALUME® and LEGION® are registered trademarks of LEGION LIGHTING CO., INC. TEX-TONE™ is a trademark of LEGION LIGHTING CO., INC.

ORDERING DATA

Nom. Size	No. and Type Lamps	Specify Ceiling	Wt.	Catalog No.
1' x 2'	▲ 1-F40TT/RS	F, J, S	16	5812WW-1BX40 EBX
	▲ 1-F50TT/RS			5812WW-1BX50 EBX
	1-F14-T5			5812WW-114
	2-F14-T5			5812WW-214
	1-F24HO-T5			5812WW-124HO
	2-F24HO-T5			5812WW-224HO
1' x 4'	▲ 2-F40TT/RS	F, J, S	32	5814WW-2BX40 EBX
	▲ 2-F50TT/RS			5814WW-2BX50 EBX
	1-F28-T5			5814WW-128
	2-F28-T5			5814WW-228
	1-F54HO-T5			5814WW-154HO
	2-F54HO-T5			5814WW-254HO

▲ F40TT/RS, F50TT/RS and F55TT/RS are the ANSI designation of various lamp manufacturers, i.e.: G.E. Lighting "BIAX", Phillips "PL", Osram "Dulux L", Sylvania TWIN TUBE.
Consult factory for F55TT/RS lamp, and change last digits of catalog number from 50 to 55.

OPTIONS

Suffix "LT" after catalog no. for cold weather ballast.
Suffix "EM" after catalog no. for emergency battery pack, see price list for types.
Suffix "DL" after catalog no. for damp location.
Suffix "XTALD" after catalog no. and consult factory.
For a HI-TECH visual appearance, a linear ribbed matte diffuse XTRALUME® reflector is optionally available in lieu of the standard white TEX-TONE™ reflector.

LAMP SHIELDS

Perforated metal shields with white acrylic overlay is standard.

OPTIONAL LAMP SHIELDS

Suffix "MPF" after catalog no. for perforated metal shields without white acrylic overlay.
Suffix "MSS" after catalog no. for non-perforated solid metal shields.

ENERGY SAVING BALLASTS Where applicable (consult factory).
Suffix "ESB" after catalog number, then / and one of the following:

ELECTRONIC

"EBX"-Electronic (BIAX) Twin Tube Ballast
"EBDX"-Electronic (BIAX) Twin Tube Dimming Ballast
"EBDP"-Electronic T5 Dimming Ballast

CEILING

- ++ Type (J) Exposed inverted "T" ceiling.
 - ++ Type (J) Concealed inverted "T" ceiling.
 - ++ Type (J) Exposed inverted "T", Tegular ceiling.
 - ++ Type (J) Exposed inverted "T", Fineline ceiling.
 - + Type (F) Flanged, Concealed "Z" spline ceiling.
 - + Type (S) Flush, Concealed "Z" spline ceiling.
- ++ (J) Exposed troffer supplied with pull-out clips. The corners of the ceiling opening should be well supported to withstand the weight of the troffer.
+ (F) Flanged and (S) Flush troffers provided with leveling jacks. Z splines must face outward from troffer.

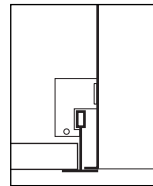

EXPOSED "T" BAR
Type "J" Lay-In

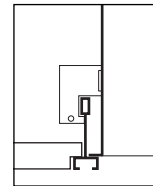

FINE LINE
Type "J" Lay-In

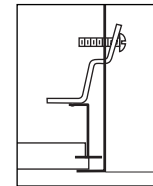

CONCEALED "Z" BAR
Type "F" Flanged trim

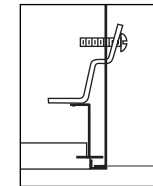

CONCEALED "Z" BAR
Type "S" Slip-In
flush trim

PHOTOMETRIC DATA - Illuminance (Footcandles)

	0.00	1.00	2.00	3.00	4.00	5.00	6.00	7.00	8.00	9.00	10.00	11.00	12.00	13.00	14.00	15.00	16.00	17.00	18.00	19.00	20.00	21.00	22.00	23.00	24.00
8.00	11.8	17.0	13.2	10.7	9.4	7.9	7.6	7.4	7.2	6.9	7.3	6.8	6.8	6.8	7.3	6.9	7.2	7.4	7.6	8.0	9.5	10.9	13.5	17.7	12.5
7.00	79.5	113.3	122.1	122.8	121.7	122.0	122.8	121.9	120.5	121.6	122.5	121.6	120.3	121.6	122.5	121.6	120.6	121.9	122.8	122.0	121.8	123.1	122.5	114.1	81.5
6.00	57.6	78.2	85.3	87.4	87.7	87.7	88.3	88.0	87.8	88.0	88.2	87.9	87.5	88.0	88.2	87.9	87.7	88.1	88.3	87.8	87.8	87.5	85.4	78.4	57.9
5.00	37.8	48.8	52.5	54.2	55.1	54.9	55.4	55.5	55.5	55.5	55.6	55.6	55.4	55.6	55.6	55.5	55.5	55.6	55.4	54.9	55.1	54.2	52.5	48.6	37.6
4.00	25.4	32.5	34.6	35.8	36.6	36.6	37.1	37.4	37.4	37.5	37.5	37.6	37.5	37.6	37.6	37.5	37.5	37.4	37.1	36.6	36.6	35.8	34.5	32.1	25.3
3.00	20.8	23.4	24.4	25.2	26.0	26.0	26.5	26.8	27.0	27.0	27.1	27.2	27.1	27.2	27.1	27.0	27.0	26.8	26.5	26.0	25.9	25.1	24.2	22.0	20.4
2.00	16.3	18.0	18.6	19.2	19.8	20.0	20.4	20.8	21.0	21.1	21.2	21.2	21.2	21.3	21.2	21.1	21.0	20.8	20.4	20.0	19.8	19.1	18.4	17.6	15.9
1.00	13.6	14.9	15.3	15.8	16.4	16.5	16.9	17.2	17.4	17.6	17.6	17.8	17.7	17.8	17.8	17.6	17.4	17.2	16.9	16.5	16.5	15.7	15.1	14.6	13.2
0.00	9.7	11.9	12.6	13.1	13.8	13.9	14.2	14.5	14.7	14.8	15.6	15.0	14.9	15.0	15.6	14.8	14.7	14.5	14.2	13.9	13.8	13.1	12.5	11.7	9.5

6-Fixtures Continuous
Mounted 2'-0" from wall

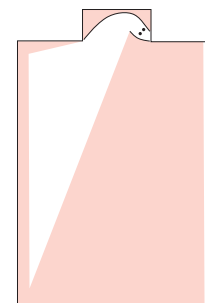

Catalog Number J5814WW-2BX40

Illumination levels indicated are computed with © Lumen-Micro Version 7.5 based on the following Room Reflectance Factors:

Ceiling 80%; Walls 50%; Floor 20%

Wall Size:

24'-0" x 8'-0"

Light Loss Factor:

(LLD) x (LDD) x (BF) = 1.0

LTL Test Report #04236 (F40TT/RS)

3150 lumens per lamp

Minimum fc: 37

Maximum fc: 59

Average fc: 52

Watts/ft²: 1.9

© Lumen-Micro Version 7.5 is software Copyright of Lighting Technologies, Inc.

Information supplied primarily for illustrative purposes, subject to change. Consult factory for verification and minimum quantity orders. Photometrics and/or performance summaries for your particular layout available, consult factory.